



LP-35-SG-TPE Essentials Refrigerator

Features:

Temperature Control	Temperature controlled microprocessor with digital display. Audible and visual temperature alarms.
Interior/Exterior Finish	High impact white, baked, anti corrosive enamel with stainless steel floor.
Door	Two pane thermally dynamic doors designed to minimize heat penetration and maintain clear visibility.
Insulation	State of the art construction materials include high density, CFC free closed cell, expanded polyurethane injected foam insulation.
Warranty (Domestic)	Three (3) year parts and labor warranty. Five (5) year compressor warranty.
Standard Unless Specified	Condensate Evaporator Pan, Door Locks, 3/4" Probe Port, LED Lighting
Specifications subject to change without notice	

Options

- | | | |
|--|---|--|
| <ul style="list-style-type: none"> • Seismic bracing • Data logger • Web based monitoring system • Static IP address | <ul style="list-style-type: none"> • Hospital grade receptacles • Multi Probe Alarm • 100% UVA/AVB protective film • Chart recorder w/ battery backup | <ul style="list-style-type: none"> • Certifications available on request • Hi/Low A/V alarm w/ battery backup, remote dry contacts |
|--|---|--|

Specifications:

Capacity	35 Cu. Ft
Temperature Range: Refrigerator	2°C to 8°C
Exterior (w x d x h)	43½" x 29½" x 78¼"
Interior (w x d x h)	38¾" x 27½" x 60⅜"
Shelves	8
System Type	Capillary Tube
Refrigerant	R134a
Compressor	1/3
Defrost	Auto
Voltage: Domestic	115V/60Hz
Amps	7.9
Cord and Plug	NEMA 5-15P
Shipping Weight	420 lbs.



Optimal Operating Conditions

Optimal operation of this unit requires it to be located in a climate controlled facility that maintains temperatures at or below 75°F with 55% relative humidity

1-866-923-PURE • Fax 856-361-2772 • Contact: sales@tempurescientific.com • Website: www.tempurescientific.com

Front View

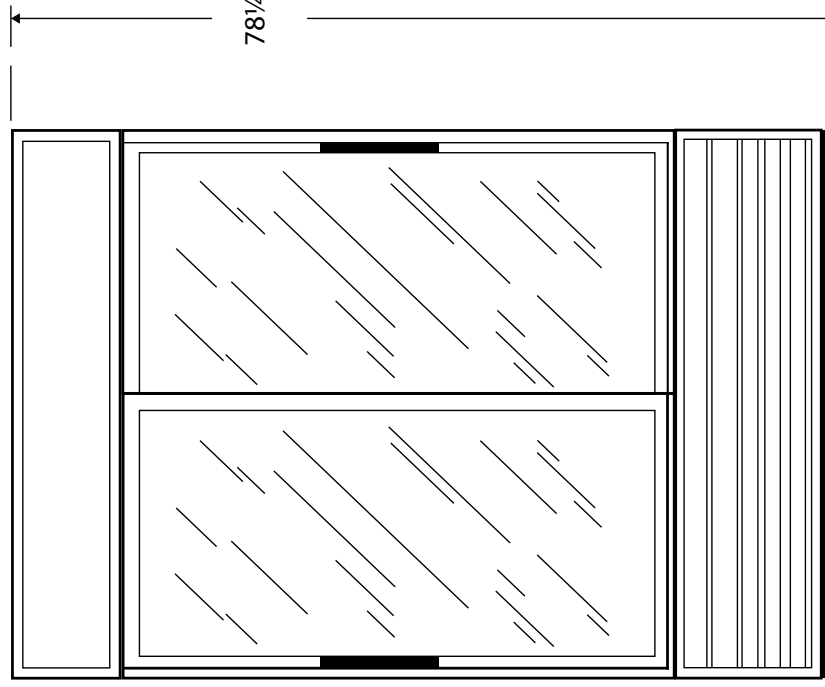

Side View

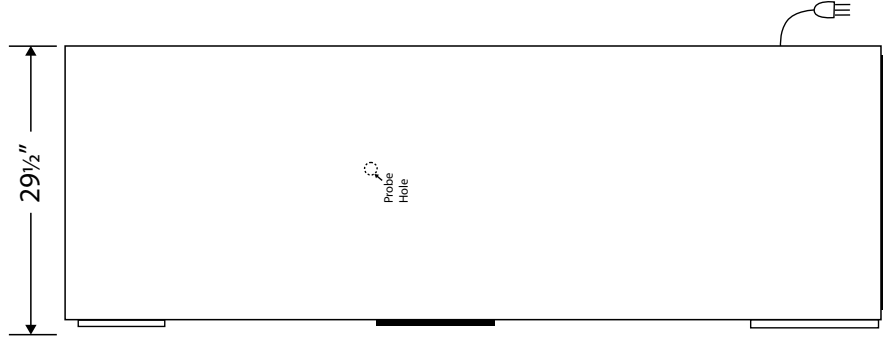

Top View

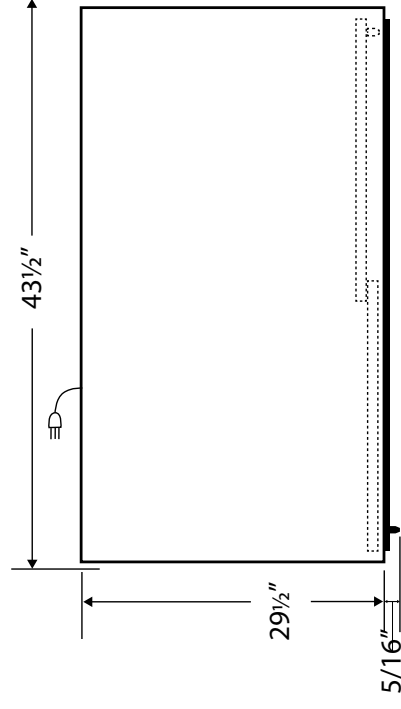

Model	Cu.Ft	Defrost	Door	Int Door	Shelves	W"	D"	H"	H.P.	Amps	Weight
LP-35-SG-TPE	35	Auto	2	0	8	43 1/2	29 1/2	78 1/4	1/3	7.9	420 lbs.

Front View

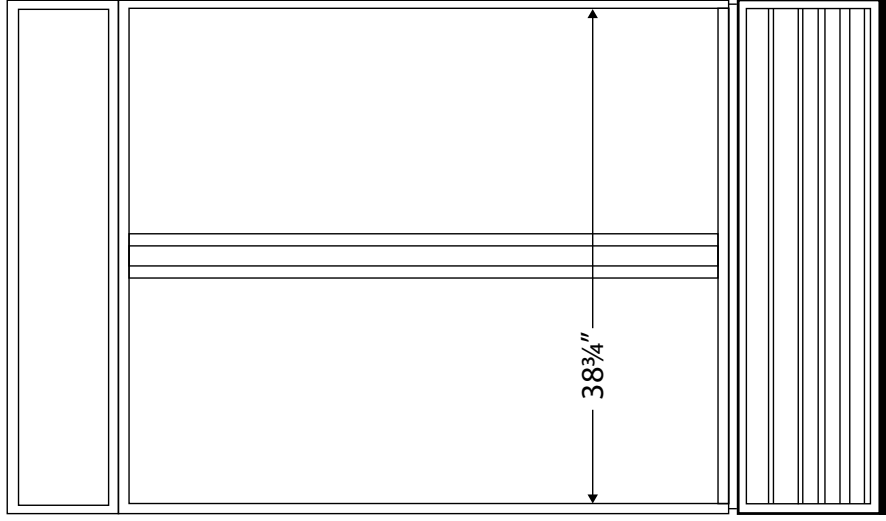

Side View

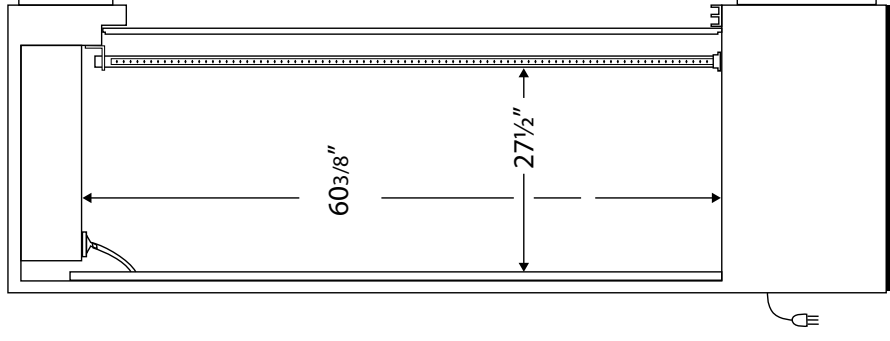

Model	Cu. Ft	Defrost	Door	Int Door	Shelves	Interior Dim.		H.P.	Amps	Weight
						W"	D" H"			
LP-35-SG-TPE	35	Auto	2	0	8	38 ³ / ₄	27 ¹ / ₂ 60 ³ / ₈	1/3	7.9	420 lbs.